

# DLSBI | Dual Shear Beam Load Cell

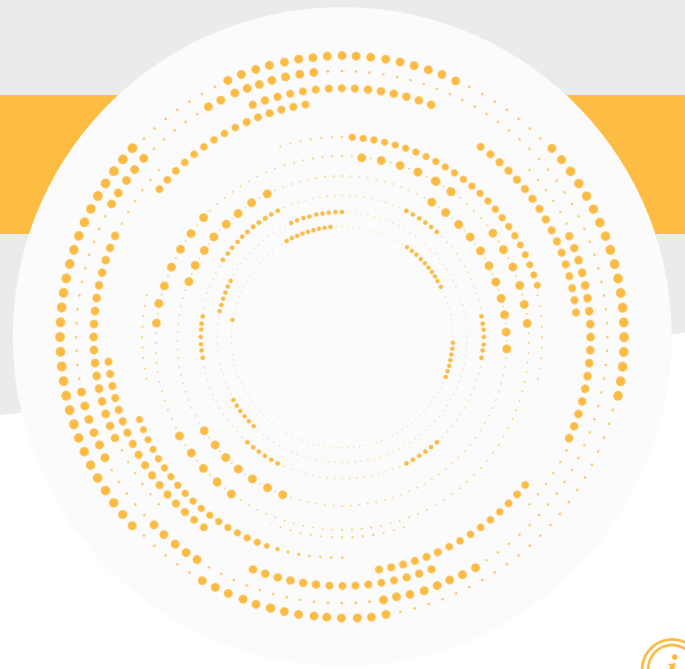

## Product Description



The DLSBI dual-shear beam load cell, available in various capacity options ranging from 5 to 20 tons, is designed to meet your high-precision measurement needs. Its durable nickel-plated alloy or stainless steel body ensures long-lasting and reliable performance, even in demanding industrial conditions.

## Technical Specifications



Capacity	5, 7.5, 15, 25 Ton	Insulation Resistance	≤ 5000 MΩ (100 VDC)
Accuracy Class	C3	Compensated Operating Temperature	-10 ~ +40 °C
Min. Load	0 kg	Operating Temperature	-30 ~ +70 °C
Max. Division Count (nLC)	1000	Recommended Excitation Voltage	10 VDC
Min. Measuring Range (Y=E <sub>max</sub> / V <sub>min</sub> )	3000	Max. Excitation Voltage (U <sub>max</sub> )	15 VDC
Total Error	±0.03 %FS	Overload Capacity	150 % FS
Output Gain (FS)	2.00 ± 0.02mV/V	Breaking Load	300 % FS
Zero Balance	± 1 %FS	Protection Class	IP 68
Input Resistance	750 Ω ± 20 Ω	Material	Alloy / Stainless Steel
Output Resistance	702 Ω ± 3 Ω	Cable	4x0.22mm <sup>2</sup>

## Technical Dimensions and Drawings

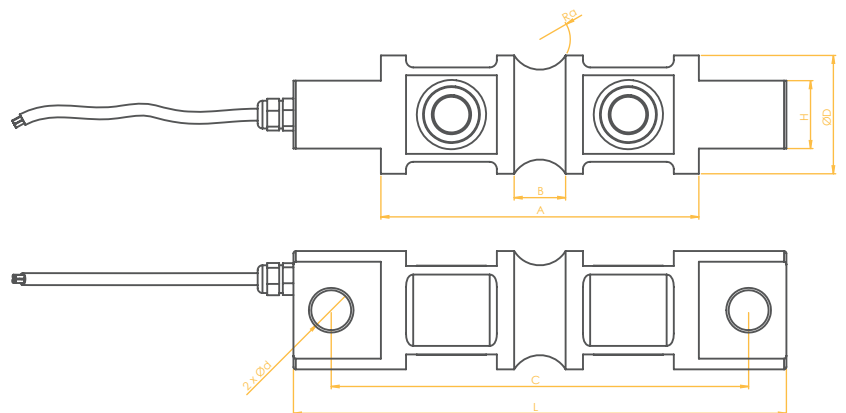
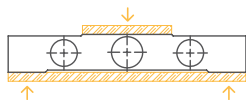
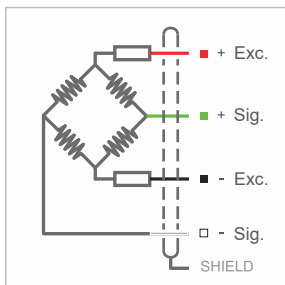

## Application Areas

On-Vehicle Weighing Applications  
Tank and Silo Weighing

Capacity	L	A	B	C	D	H	Ra	d	Cable
5 Ton	207	133	15.7	174	43	28.5	12.7	16	7.5 m
10 Ton	206	133	21.5	174	49.5	28.4	12.7	16.7	10 m
20, 30 Ton	261	165	25.4	216	76	60.5	25.4	27	10 m



**LPTSENS**  
Load Cell and Industrial Weighing Systems